

# 16-HOLE PLANK - 30" WIDTH

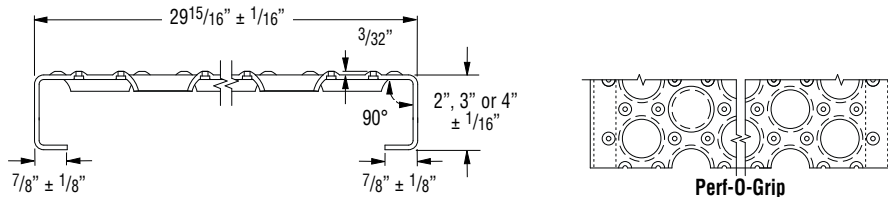

## Plank Selection/Design Tables

Allowable Loads and Deflections: U=Uniform Load (lb./ft.<sup>2</sup>) C= Concentrated Load (lb.) D=Deflection (in.)

Material Gauge	Channel Depth in. (mm)	Weight lb./lin. ft. (kg/m)	Catalog Number		Span																
					2'-0"	2'-6"	3'-0"	3'-6"	4'-0"	4'-6"	5'-0"	5'-6"	6'-0"	6'-6"	7'-0"	7'-6"	8'-0"	9'-0"	10'-0"	11'-0"	12'-0"
Steel 11 ga.	2" (50.8)	11.8 (17.5)	P162011	U	956	612	425	312	239	189	153	126	106	91	77	68	60	47	38	32	27
				D	.02	.03	.04	.05	.07	.09	.11	.13	.16	.18	.21	.24	.28	.35	.43	.52	.62
				C	2564	2051	1709	1465	1282	1140	1026	932	855	789	733	684	641	570	513	466	427
				D	.01	.02	.03	.04	.06	.07	.09	.10	.12	.15	.17	.20	.22	.28	.35	.42	.50
	3" (76.2)	12.7 (18.9)	P163011	U	1413	904	628	461	353	279	226	187	157	134	116	100	89	70	57	46	39
				D	.02	.03	.04	.06	.08	.10	.12	.14	.17	.20	.23	.26	.30	.38	.47	.57	.67
				C	3802	3041	2534	2172	1901	1690	1521	1382	1267	1170	1086	1014	950	845	760	691	634
				D	.01	.02	.03	.04	.05	.07	.09	.10	.12	.14	.17	.19	.22	.28	.34	.41	.53
	4" (101.6)	13.5 (20.1)	P164011	U	2240	1434	996	731	560	443	358	296	249	212	183	159	140	111	91	75	64
				D	.01	.02	.03	.04	.06	.07	.09	.11	.13	.15	.17	.20	.23	.29	.36	.44	.52
				C	5838	4670	3892	3336	2919	2595	2335	2123	1946	1796	1668	1557	1459	1297	1168	1061	973
				D	.01	.02	.02	.03	.04	.05	.07	.08	.09	.11	.13	.15	.17	.21	.26	.32	.38

**Perfo-Grip:** To order standard Perfo-Grip Grating use part number "Pxxxxx".  
Standard lengths are 10'-0" and 12'-0". Longer lengths of 20'-0" and 24'-0" are available.