

# TRACTION TREAD™ LADDER RUNGS

## *Traction Tread Ladder Rungs*

Traction Tread™ Ladder Rungs feature a hand-over-hand friendly surface with moderate slip resistance. Products are sold in efficient lengths, well suited to fabricators of ladders. Vehicle applications are extensive.

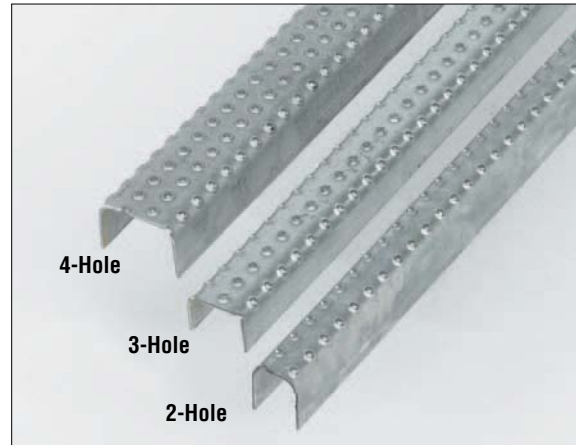

### 2-Hole Ladder Rung

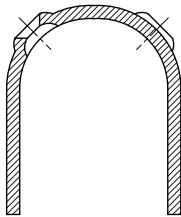

- Hot rolled, pickled and oiled carbon steel: 13 gauge (1.2 lbs./ft.)
- Aluminum alloy 5052-H32: .125" (0.5 lbs./ft.)
- 1 1/4" wide x 1 1/2" high x 48" or 60" long

### 3-Hole Ladder Rung

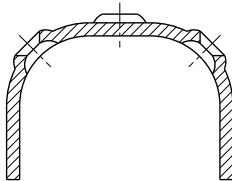

- Hot rolled, pickled and oiled carbon steel: 13 gauge (1.3 lbs./ft.)
- Aluminum alloy 5052-H32: .125" (0.5 lbs./ft.)
- 1 5/8" wide x 1 1/8" high x 48" or 60" long

### 4-Hole Ladder Rung

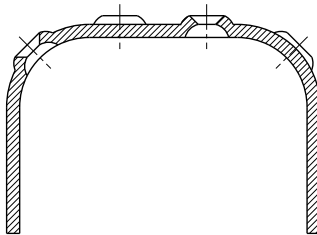

- Hot rolled, pickled and oiled carbon steel: 13 gauge (1.5 lbs./ft.)
- Aluminum alloy 5052-H32: .125" (0.7 lbs./ft.)
- 2 1/4" wide x 1 1/2" high x 48" or 60" long

**2, 3 & 4-Hole Ladder Rungs Are Also Available In 16 Gauge 304 Stainless Steel.**